

TRAFFIC SWINGING SINGLE LEAF DOORS WITH TORSION HINGES

ALL PRICES IN US DOLLARS, 2 MM THICK DOOR FRAME INCLUDED, VAT NOT INCLUDED

(TSD TH)

30.10.2023

- PH Insulation's traffic swinging doors are designed to separate production and other premises in places with intensive traffic of personnel. The factory-made doors are ready for installation on technological, industrial premises, supermarkets, hospitals, food production facilities, cafes, restaurants, etc. Doors can be equipped with oval windows of 200x500 or 300x580 mm.
- PH Insulation's doors with torsion hinges automatically return to the closed position and remain closed even in strong wind.
- All elements of torsion hinges are made of steel.
- Torsion hinges are less visible in the interior compared to standard hinges.

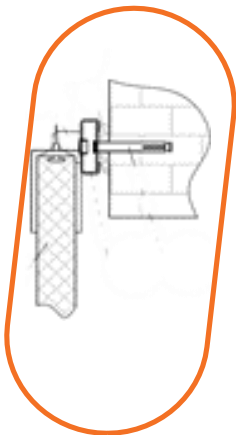

OVERHEAD FRAME

RAL 9003	INSTALLATION OPENING, HEIGHT, MM	INSTALLATION OPENING, WIDTH, MM					
		700	800	900	1000	1100	1200
1800	375	382	389	400	407	422	492
1900	378	388	395	406	413	486	499
2000	382	393	400	412	419	493	505
2100	386	398	406	417	481	499	512
2200	390	404	411	423	487	505	518
2300	398	413	421	489	498	516	590
2400	406	423	431	500	509	528	602
2500	477	492	501	516	525	545	621
2600	487	504	513	528	537	618	634
2700	494	511	520	535	545	626	643
2800	500	518	528	543	612	635	652
2900	565	582	592	609	620	643	661
3000	571	589	600	617	628	652	669
3100	576	595	606	624	635	659	677
3200	582	603	614	631	643	667	686
3300	590	611	623	641	652	677	696

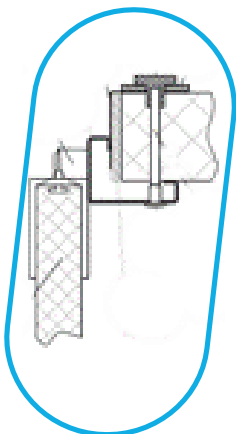

ANGULAR FRAME

RAL 9003	INSTALLATION OPENING, HEIGHT, MM	INSTALLATION OPENING, WIDTH, MM					
		700	800	900	1000	1100	1200
1800	394	403	411	420	427	444	515
1900	398	409	417	426	434	509	522
2000	407	419	427	437	445	521	535
2100	412	425	433	444	509	528	542
2200	416	431	440	450	516	535	549
2300	425	442	450	518	528	547	623
2400	434	452	461	530	539	560	636
2500	503	519	529	541	551	572	649
2600	511	529	539	552	562	643	661
2700	518	537	547	560	571	653	670
2800	525	545	556	569	638	662	680
2900	591	610	621	635	647	671	689
3000	596	616	627	642	653	678	696
3100	602	624	635	650	662	687	706
3200	612	634	646	661	673	699	718
3300	619	643	655	670	682	709	728

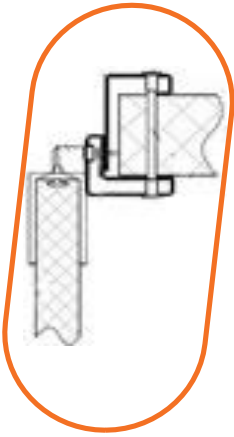

OVERLAPPING FRAME

INSTALLATION OPENING, HEIGHT, MM	INSTALLATION OPENING, WIDTH, MM						
	700	800	900	1000	1100	1200	1300
1800	464	476	485	496	508	525	592
1900	471	484	494	505	518	596	602
2000	483	498	507	520	532	611	617
2100	490	506	516	529	602	621	627
2200	497	515	525	538	611	631	637
2300	510	529	539	612	627	647	716
2400	522	543	553	628	642	663	733
2500	603	622	634	650	665	687	757
2600	615	635	647	663	678	764	771
2700	625	646	658	674	690	776	784
2800	634	657	670	686	764	788	796
2900	706	728	741	759	776	801	809
3000	710	733	747	764	782	807	815
3100	720	744	758	775	793	819	827
3200	736	761	775	793	812	838	847
3300	745	772	787	805	824	851	860

RAL 9003

ALL DOORS ARE AVAILABLE IN CUSTOM SIZES TO INSURE BEST COMMERCIAL APPLICATION

TRAFFIC SWINGING DOUBLE LEAF DOORS WITH TORSION HINGES

ALL PRICES IN US DOLLARS, 2 MM THICK DOOR FRAME INCLUDED, VAT NOT INCLUDED

(TDD TH)

30.10.2023

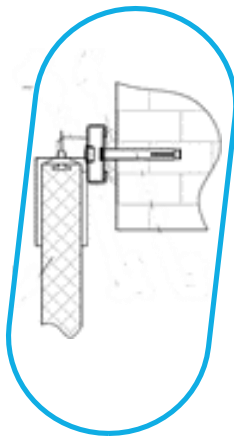

OVERHEAD FRAME

INSTALLATION OPENING, HEIGHT, MM	INSTALLATION OPENING, WIDTH, MM				
	1000	1100	1200	1300	1400
1800	587	590	596	599	656
1900	593	596	603	606	666
2000	600	603	610	613	676
2100	606	609	616	620	686
2200	612	616	623	627	696
2300	625	629	636	640	713
2400	638	642	649	653	730
2500	757	761	769	773	853
2600	773	777	785	789	873
2700				800	887
2800				811	901
2900				934	1027
3000				945	1041
3100				954	1054
3200				965	1068
3300				977	1083

RAL 9003

OVERHEAD FRAME

RAL 9003	INSTALLATION OPENING, HEIGHT, MM	INSTALLATION OPENING, WIDTH, MM				
		1500	1600	1700	1800	1900
1800	659	662	665	668	671	
1900	669	672	675	678	681	
2000	679	682	686	689	692	
2100	689	693	696	699	703	
2200	699	703	706	710	713	
2300	717	720	724	727	843	
2400	734	738	742	745	862	
2500	857	861	865	869	873	
2600	877	881	885	889	893	
2700	891	895	899	904	908	
2800	905	909	914	918	923	
2900	1032	1037	1041	1046	1050	
3000	1046	1051	1055	1060	1065	
3100	1059	1064	1068	1073	1078	
3200	1073	1078	1083	1088	1092	
3300	1088	1093	1098	1104	1109	

OVERHEAD FRAME

RAL 9003	INSTALLATION OPENING, HEIGHT, MM	INSTALLATION OPENING, WIDTH, MM					
		2 000	2 100	2 200	2 300	2 400	2 500
1800	674	677	679	682	685	799	802
1900	684	687	690	804	807	810	813
2000	695	698	702	815	818	822	825
2100	706	820	823	826	830	833	836
2200	717	831	834	838	841	845	848
2300	846	850	854	857	861	976	980
2400	866	870	873	877	881	998	1001
2500	877	881	885	889	892	1009	1013
2600	898	902	906	1023	1027	1031	1035
2700	912	917	921	1038	1042	1047	1051
2800	927	1044	1049	1053	1058	1062	1066
2900	1055	1059	1064	1068	1073	1078	1082
3000	1069	1074	1079	1084	1088	1093	1098
3100	1083	1088	1092	1097	1102	1107	1112
3200	1098	1102	1107	1112	1117	1122	1127
3300	1114	1119	1124	1129	1134	1139	1144

ANGULAR FRAME

RAL 9003	INSTALLATION OPENING, HEIGHT, MM	INSTALLATION OPENING, WIDTH, MM			
		1000	1100	1200	1300
1800	602	606	613	616	673
1900	610	613	620	623	684
2000	617	620	627	631	694
2100	624	627	635	638	705
2200	637	641	649	652	723
2300	651	655	662	666	741
2400	664	668	677	681	759
2500	783	787	795	799	880
2600	797	801	809	814	898
2700				825	912
2800				837	927
2900				961	1055
3000				970	1067
3100				982	1082
3200				996	1099
3300				1007	1114

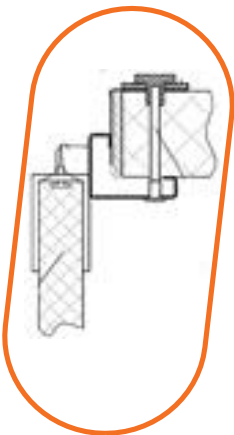

ANGULAR FRAME

	INSTALLATION OPENING, HEIGHT, MM	INSTALLATION OPENING, WIDTH, MM				
		1500	1600	1700	1800	1900
RAL 9003	1800	676	679	683	686	689
	1900	687	690	694	697	700
	2000	698	701	705	708	712
	2100	708	712	716	719	723
	2200	726	730	734	738	741
	2300	745	748	752	756	773
	2400	763	767	771	775	793
	2500	884	889	893	897	902
	2600	902	907	911	916	920
	2700	917	922	926	931	935
	2800	932	937	941	946	951
	2900	1060	1064	1069	1074	1079
	3000	1072	1077	1082	1087	1092
	3100	1087	1092	1097	1102	1107
	3200	1104	1109	1115	1120	1125
	3300	1119	1124	1130	1135	1141

ANGULAR FRAME

	INSTALLATION OPENING, HEIGHT, MM	INSTALLATION OPENING, WIDTH, MM						
		2 000	2 100	2 200	2 300	2 400	2 500	2 600
RAL 9003	1800	692	695	698	702	705	819	822
	1900	704	707	710	824	827	831	834
	2000	715	718	722	836	839	843	846
	2100	726	841	844	848	851	855	859
	2200	745	861	864	868	872	876	880
	2300	877	881	885	889	893	1010	1014
	2400	897	902	906	910	914	1032	1036
	2500	906	910	915	919	923	1040	1045
	2600	924	929	933	1051	1055	1060	1064
	2700	940	945	949	1067	1071	1076	1080
	2800	956	1073	1078	1083	1087	1092	1097
	2900	1084	1089	1094	1098	1103	1108	1113
	3000	1097	1102	1107	1112	1117	1122	1126
	3100	1112	1117	1122	1127	1132	1138	1143
	3200	1131	1136	1141	1146	1152	1157	1162
	3300	1146	1151	1157	1162	1168	1173	1178

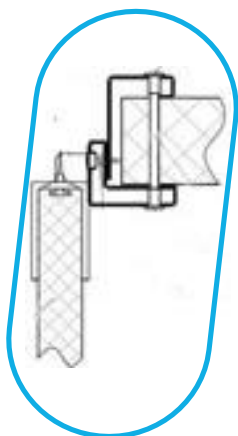

OVERLAPPING FRAME

	INSTALLATION OPENING, HEIGHT, MM	INSTALLATION OPENING, WIDTH, MM				
		1000	1100	1200	1300	1400
RAL 9003	1800	678	683	691	695	756
	1900	689	694	702	707	770
	2000	700	705	713	718	785
	2100	710	715	724	729	799
	2200	723	728	737	742	816
	2300	740	745	755	760	838
	2400	761	766	776	781	863
	2500	872	877	887	892	976
	2600	888	894	904	909	996
	2700				924	1013
	2800				939	1032
	2900				1068	1164
	3000				1076	1175
	3100				1089	1192
	3200				1110	1216
3300				1124	1233	

OVERLAPPING FRAME

	INSTALLATION OPENING, HEIGHT, MM	INSTALLATION OPENING, WIDTH, MM				
		1500	1600	1700	1800	1900
RAL 9003	1800	760	765	769	773	778
	1900	775	780	784	789	793
	2000	790	795	799	804	809
	2100	804	809	814	819	823
	2200	821	826	831	836	842
	2300	843	848	854	859	880
	2400	869	874	880	885	1009
	2500	981	987	992	998	1003
	2600	1002	1007	1013	1019	1024
	2700	1019	1025	1031	1037	1043
	2800	1038	1044	1050	1056	1062
	2900	1170	1176	1182	1189	1195
	3000	1181	1187	1194	1200	1206
	3100	1198	1205	1211	1217	1224
	3200	1223	1229	1236	1242	1249
	3300	1240	1247	1253	1260	1267

OVERLAPPING FRAME

	INSTALLATION OPENING, HEIGHT, MM	INSTALLATION OPENING, WIDTH, MM						
		2 000	2 100	2 200	2 300	2 400	2 500	2 600
RAL 9003	1800	782	787	791	796	800	919	923
	1900	798	802	807	926	931	935	940
	2000	814	818	823	943	947	952	957
	2100	828	948	953	958	963	968	973
	2200	847	967	972	977	982	987	992
	2300	986	991	996	1001	1007	1129	1134
	2400	1014	1020	1025	1031	1036	1160	1165
	2500	1009	1015	1020	1026	1032	1152	1157
	2600	1030	1036	1042	1162	1168	1174	1179
	2700	1049	1054	1060	1181	1186	1193	1198
	2800	1068	1188	1194	1200	1207	1213	1219
	2900	1201	1207	1213	1219	1226	1232	1238
	3000	1212	1218	1225	1231	1237	1244	1250
	3100	1230	1237	1243	1249	1256	1262	1269
	3200	1256	1262	1269	1275	1282	1288	1295
	3300	1274	1280	1287	1294	1301	1307	1314

ALL DOORS ARE AVAILABLE IN CUSTOM SIZES TO INSURE BEST COMMERCIAL APPLICATION

DOOR CATALOGUE CODES

TSD TH
TDD TH
RIGHT / LEFT

TRAFFIC SWINGING SINGLE LEAF DOORS WITH TORSION HINGES
TRAFFIC SWINGING DOUBLE LEAF DOORS WITH TORSION HINGES
HINGES ON THE RIGHT / HINGES ON THE LEFT

EXAMPLE OF DOOR CATALOGUE CODE: TSD TH 800 2000 40 RAL9003/RAL9003 ANG RIGHT

DOOR TYPE	DOORWAY WIDTH	DOORWAY HEIGHT	DOOR THICKNESS	DOOR LEAF METAL		FRAME TYPE	HINGES LOCATION
				EXTERIOR	INTERIOR		
TSD TH	800	2000	40	RAL9003	RAL9003	ANGULAR	RIGHT

ADDITIONAL OPTIONS FOR TRAFFIC SWINGING DOORS

ITEM	PRICE
TDD FRAME INSTALLATION HARDWARE TO INSULATED SANDWICH PANELS	13
TSD FRAME INSTALLATION HARDWARE TO INSULATED SANDWICH	9
TDD FRAME INSTALLATION HARDWARE TO A BRICK WALL	8
TSD FRAME INSTALLATION HARDWARE TO A BRICK WALL	4
FRAME INSTALLATION HARDWARE FOR STEEL STUD CONSTRUCTION	2
DOOR BLADE MATERIAL: AISI 304, PRICE FOR 1 SQ. M	33
DOOR BLADE MATERIAL: AISI 430, PRICE FOR 1 SQ. M	23
OVERHEAD FRAME AISI 304, PRICE FOR RUNNING METER	18
ANGULAR FRAME AISI 304, PRICE FOR RUNNING METER	31
OVERLAPPING FRAME AISI 304, PRICE FOR RUNNING METER	82
OVERHEAD FRAME AISI 430, PRICE FOR RUNNING METER	11
ANGULAR FRAME AISI 430, PRICE FOR RUNNING METER	18
OVERLAPPING FRAME AISI 430, PRICE FOR RUNNING METER	47
HIDDEN INSTALLATION HARDWARE FOR TSD	45
HIDDEN INSTALLATION HARDWARE FOR TDD	53
HIDDEN INSTALLATION HARDWARE FOR TSD WITH AISI 304 FRAME	62
HIDDEN INSTALLATION HARDWARE FOR TDD WITH AISI 304 FRAME	73
HIDDEN INSTALLATION HARDWARE FOR TSD WITH AISI 430 FRAME	55
HIDDEN INSTALLATION HARDWARE FOR TDD WITH AISI 304 FRAME	65

FACTORY INSTALLED BUMPERS FOR TSD TH

BUMPER MATERIAL	THICKNESS, MM	PRICE FOR SQ. M	PRICE FOR RUNNING METER	
			BOTTOM 0,25 M	BOTTOM 0,5 M
AISI 304	1,5	110	27	55
AISI 430	1,5	73	18	36
ALUMINIUM CHECKER PLATE	1,5	58	14	29
FLAT HDPE PLASTIC	4,0	33	8	16
CURVED HDPE PLASTIC	6,0	47	12	24

FACTORY INSTALLED BUMPERS FOR TDD TH

BUMPER MATERIAL	THICKNESS, MM	PRICE FOR SQ. M	PRICE FOR RUNNING METER	
			BOTTOM 0,25 M	BOTTOM 0,5 M
AISI 304	1,5	115	29	58
AISI 430	1,5	76	19	38
ALUMINIUM CHECKER PLATE	1,5	61	15	31
FLAT HDPE PLASTIC	4,0	34	8	17
CURVED HDPE PLASTIC	4,0	39	10	19
CURVED HDPE PLASTIC	6,0	48	12	24

PACKAGING

ITEM	PRICE
STRETCH-WRAP	INCLUDED IN DOOR PRICE
CARDBOARD PACKAGING	CALCULATED INDIVIDUALLY FOR YOUR ORDER
WOODEN PACKAGING	CALCULATED INDIVIDUALLY FOR YOUR ORDER

